

GGDSR Drawer Damper

Features

- Used with slide to reduce shock when closing the drawer
- Creates a "soft-close" effect
- Passed 25,000 life cycle test

Notes

- Latch is required to hold the drawer in closed position
- It is an oil damper, improper usage may result in leak
- Dimension marked with ※ below has to be minimum 30 mm

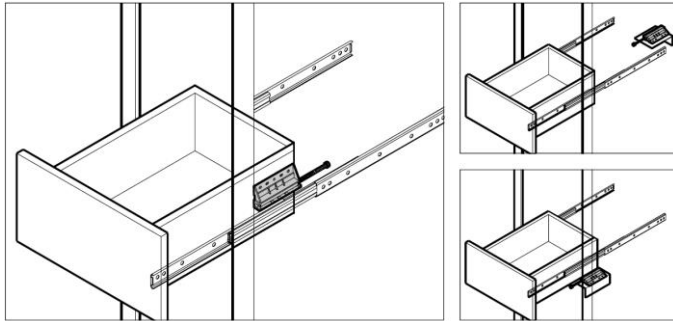

| No. | Part Name | Material | Colour |
|-----|-----------|----------|------------|
| ① | Bracket | ABS | Light Grey |
| ② | Body | POM | Grey |
| ③ | Bumper | PUR | Red |

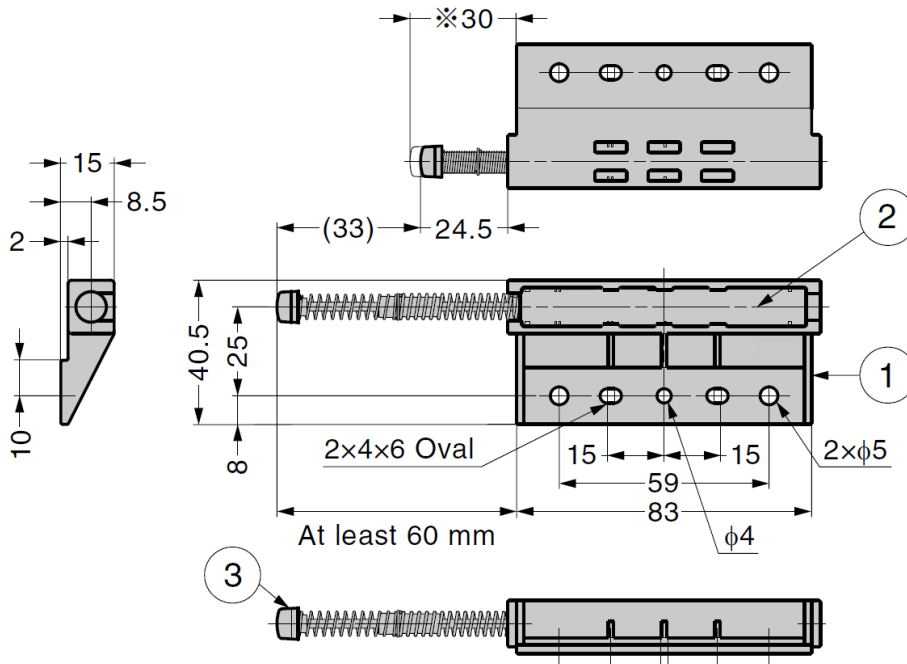

| Part No. | Reaction Force | |
|------------|----------------|------|
| GGDSR144-R | 20 N | 2 kg |